



SPECIAL MESH BAR GRATING

# special mesh (metric)

## SPECIAL CLOSE MESH (METRIC)

Deflections as per table on page 12.

### Type 18 Metric

ADA Compatible with 4.8mm bars   
Multiply load values by 1.72 as per table on page 12.

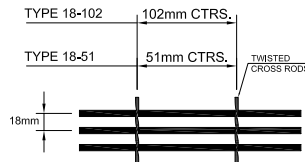

### Type 24 Metric

Multiply load values by 1.25 as per table on page 12.

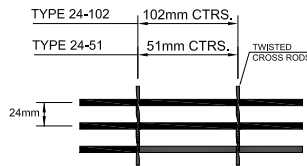

## SPECIAL WIDE MESH (METRIC)

Deflections as per table on page 12.

### Type 41 Metric

Multiply load values by 0.73 as per table on page 12.

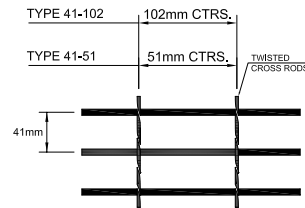

### Type 48 Metric

Multiply load values by 0.63 as per table on page 12.

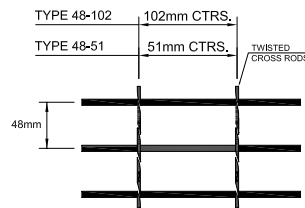

### Type 60 Metric

Multiply load values by 0.50 as per table on page 12.

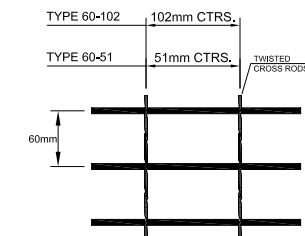

METRIC PANEL WIDTH IN MILLIMETRES  
(For 4.8mm bearing bars)

# OF BARS	CLOSE MESH		STANDARD MESH	WIDE MESH		
	TYPE 18 METRIC	TYPE 24 METRIC	TYPE 30 METRIC	TYPE 41 METRIC	TYPE 48 METRIC	TYPE 60 METRIC
2	22	28	35	46	52	65
3	40	52	65	87	100	125
4	57	76	95	129	148	186
5	75	100	125	170	195	246
6	92	124	156	211	243	306
7	110	148	186	252	291	367
8	127	171	216	294	338	427
9	144	195	246	335	386	487
10	162	219	276	381	433	548
11	179	243	306	418	481	608
12	197	267	337	459	529	668
13	214	291	367	500	576	729
14	232	314	397	541	624	789
15	249	338	427	583	683	849
16	267	362	457	624	719	910
17	284	386	487	665	767	
18	302	410	518	706	814	
19	319	433	548	748	862	
20	337	457	578	789	910	
21	354	481	608	830		
22	371	505	638	872		
23	389	529	668	913		
24	406	552	698			
25	424	576	729			
26	441	600	759			
27	459	624	789			
28	476	648	819			
29	494	672	849			
30	511	695	879			
31	529	719	910			
32	546	743				
33	564	767				
34	581	790				
35	598	814				
36	615	838				
37		862				
38		886				
39		910				
40						
41						

Dimensions shown are out to out of bearing bars.  
For 3.2mm bearing bars, deduct 1.6mm from panel width.  
All metric dimensions are based on a "soft" conversion.

\*All weights will increase by 5% when galvanized.