



STANDARD MESH BAR GRATING

STANDARD TRU-WELD – TYPE 30 (METRIC)

Bearing Bars: 30mm centers

Stock panels: 915mm nominal width x 7315mm long

type 30 metric

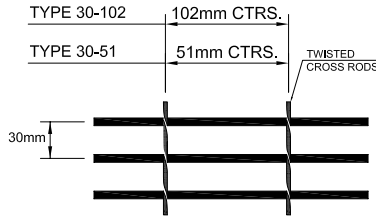
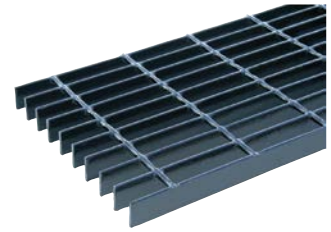

METRIC LEGEND

U = Safe Uniform Load (kPa)

C = Safe Concentrated Load (kN/metre of grating width)

D = Deflection (mm)

Loads and deflections given in this table are theoretical and are based on a maximum allowable fibre stress of 124.0 MPa. All metric dimensions are based on a "soft" conversion.

BEARING BAR SIZE (mm)	APPROX. WEIGHT (kg/m ²)		LOAD/ DEFLECTION	SPAN IN MILLIMETRES (mm)														SECTION MODULUS PER 305mm OF WIDTH											
	TYPE 30-102	TYPE 30-51		610	762	914	1067	1219	1372	1524	1676	1829	1981	2134	2286	2438	2591		2743										
19 x 4.8	27.2		U	25.52	16.33	11.34	8.33	6.38	5.04	Spans and loads in the green shaded area exceed a deflection of 6mm for uniform loads of 5kPa. Experience has shown that 6mm deflection is the maximum deflection to give pedestrian comfort, but can be exceeded for other types of loads at the discretion of the engineer. For serrated surface, increase depth by one size.										3000									
			D	2.52	3.94	5.68	7.73	10.09	12.77																				
			C	7.78	6.22	5.18	4.44	3.89	3.46																				
			D	2.02	3.15	4.54	6.18	8.07	10.22																				
25 x 3.2	24.6		U	30.24	19.32	13.44	9.87	7.56	5.97	4.84	4.00	3.36											3540						
			D	1.89	2.96	4.26	5.79	7.57	9.58	11.82	14.31	17.03																	
			C	9.22	7.37	6.14	5.27	4.61	4.10	3.69	3.35	3.07																	
			D	1.51	2.36	3.41	4.64	6.05	7.66	9.46	11.45	13.62																	
25 x 4.8	35.3	38.4	U	45.36	29.03	20.16	14.81	11.34	8.96	7.26	6.00	5.04											5330						
			D	1.89	2.96	4.26	5.79	7.57	9.58	11.82	14.31	17.03																	
			C	13.83	11.06	9.22	7.90	6.91	6.14	5.53	5.03	4.61																	
			D	1.51	2.36	3.41	4.64	6.05	7.66	9.46	11.45	13.62																	
32 x 3.2	29.9	33.0	U	47.25	30.24	21.00	15.43	11.81	9.33	7.56	6.25	5.25	4.47	3.86											5560				
			D	1.51	2.36	3.41	4.64	6.05	7.66	9.46	11.45	13.62	15.99	18.54															
			C	14.40	11.52	9.60	8.23	7.20	6.40	5.76	5.24	4.80	4.43	4.11															
			D	1.21	1.89	2.72	3.71	4.84	6.13	7.57	9.16	10.90	12.79	14.83															
32 x 4.8	43.3	46.4	U	70.88	45.36	31.50	23.14	17.72	14.00	11.34	9.37	7.88	6.71	5.79											8310				
			D	1.51	2.36	3.41	4.64	6.05	7.66	9.46	11.45	13.62	15.99	18.54															
			C	21.60	17.28	14.40	12.34	10.80	9.60	8.64	7.86	7.20	6.65	6.17															
			D	1.21	1.89	2.72	3.71	4.84	6.13	7.57	9.16	10.90	12.79	14.83															
38 x 3.2	35.3	38.4	U	68.04	43.55	30.24	22.22	17.01	13.44	10.89	9.00	7.56	6.44	5.55	4.84	4.25	3.77	3.36											8000
			D	1.26	1.97	2.84	3.86	5.04	6.39	7.88	9.54	11.35	13.32	15.45	17.74	20.18	22.78	25.54											
			C	20.74	16.59	13.83	11.85	10.37	9.22	8.30	7.54	6.91	6.38	5.93	5.53	5.18	4.88	4.61											
			D	1.01	1.58	2.27	3.09	4.04	5.11	6.31	7.63	9.08	1.66	12.36	14.19	16.14	18.22	20.43											
38 x 4.8	51.3	54.4	U	102.03	65.32	45.36	33.33	25.52	20.16	16.33	13.50	11.34	9.66	8.33	7.26	6.38	5.65	5.04											11960
			D	1.26	1.97	2.84	3.86	5.04	6.39	7.88	9.54	11.35	13.32	15.45	17.74	20.18	22.78	25.54											
			C	31.11	24.89	20.74	17.78	15.55	13.83	12.44	11.31	10.37	9.57	8.89	8.30	7.78	7.32	6.91											
			D	1.01	1.58	2.27	3.09	4.04	5.11	6.31	7.63	9.08	10.66	12.36	14.19	16.14	18.22	20.43											
45 x 4.8	59.4	62.5	U	138.92	88.91	61.74	45.36	34.73	27.44	22.23	18.37	15.44	13.15	11.34	9.88	8.68	7.69	6.86											16290
			D	1.08	1.69	2.43	3.31	4.32	5.47	6.76	8.18	9.73	11.42	13.24	15.20	17.63	19.53	21.89											
			C	42.34	33.87	28.23	24.20	21.17	18.82	16.94	15.40	14.11	13.03	12.10	11.29	10.59	9.96	9.41											
			D	0.86	1.35	1.95	2.65	3.46	4.38	5.41	6.54	7.78	9.13	10.59	12.16	13.84	15.62	17.51											
51 x 4.8	67.4	70.6	U	181.44	116.12	80.64	59.25	45.36	35.84	29.03	23.99	20.16	17.18	14.81	12.90	11.34	10.05	8.96											21290
			D	0.95	1.48	2.13	2.90	3.78	4.79	5.91	7.15	8.51	9.99	11.59	13.30	15.13	17.09	19.16											
			C	55.30	44.24	36.87	31.60	27.65	24.58	22.12	20.11	18.43	17.02	15.80	14.75	13.83	13.01	12.29											
			D	0.76	1.18	1.70	2.32	3.03	3.83	4.73	5.72	6.81	7.99	9.27	10.64	12.11	13.67	15.32											
57 x 4.8	75.4	78.6	U	229.64	146.97	102.06	74.98	57.41	45.36	36.74	30.37	25.52	21.74	18.75	16.33	14.35	12.71	11.34											26940
			D	0.84	1.31	1.89	2.58	3.36	4.26	5.26	6.36	7.57	8.88	10.30	11.82	13.45	15.19	17.03											
			C	69.99	55.99	46.66	40.00	35.00	31.11	28.00	25.45	23.33	21.54	20.00	18.66	17.50	16.47	15.55											
			D	0.67	1.05	1.51	2.06	2.69	3.41	4.20	5.09	6.05	7.10	8.24	9.46	10.76	12.15	13.62											
64 x 4.8	83.5	86.7	U	283.50	181.44	126.00	92.57	70.88	56.00	45.36	37.49	31.50	26.84	23.14	20.16	17.72	15.70	14.00											33250
			D	0.76	1.18	1.70	2.32	3.03	3.83	4.73	5.72	6.81	7.99	9.27	10.64	12.11	13.67	15.32											
			C	86.41	69.13	57.61	49.38	43.21	38.41	34.56	31.42	28.80	26.59	24.69	23.04	21.60	20.33	19.20											
			D	0.61	0.95	1.36	1.85	2.42	3.06	3.78	4.58	5.45	6.39	7.42	8.51	9.69	10.93	12.26											

Tru-Weld grating meets N.A.A.M.M. standards.

*All weights will increase by 5% when galvanized.